

DISCOVERY LXE/DISCOVERY

2018 FLEETWOOD
CLASS A DIESEL



DISCOVERY

The Discovery is Fleetwood's most luxurious Class A diesel, setting the benchmark in comfort with its list of standard upgrades. The 2018 Discovery combines an 84" interior ceiling height with the galley's polished solid-surface countertops and hardwood cabinet doors and drawers. For an added touch, you'll feel right at home thanks to a 22 cu. ft. residential refrigerator. The journey has never looked better than with a central vacuum system, Firefly Integrations control panel and stackable washer-dryer in the bedroom.

TOP FEATURES

- Power Bridge Chassis® on the Freightliner® XCM Series
- ISB 6.7L 360 HP with 800 ft-lb Torque
- Firefly Integrations Electronic Control System
- High Gloss Solid Hardwood Cabinetry
- Induction Cooktop
- Polished Porcelain Tile Throughout
- Residential Refrigerator
- Dishwasher
- 3RD Air Conditioner (39G Only)
- Power Water Hose Reel & Power Cord Reel
- Awning with LED Light Strip & Wind Sensor React
- BOSE™ Soundbar



The Discovery 37R is shown in Celestial Reflection décor and Autumn Wheat High Gloss cabinetry.



The Discovery 39F is shown with Dark Cherry High Gloss cabinetry and features the new 2018 Galley faucet.



DISCOVERY EXTERIOR CHOICES & FLOORPLANS

37R

Options: 087, 191, 830, 883

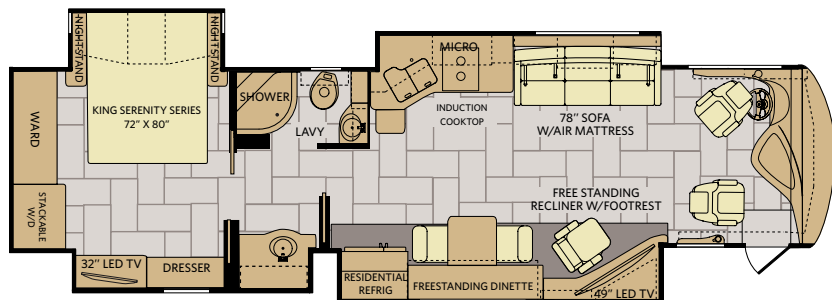

38K

Options: 087, 833

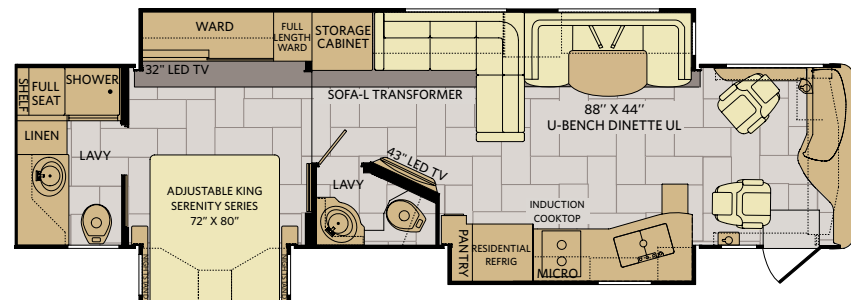

39F

Options: 087, 203, 830

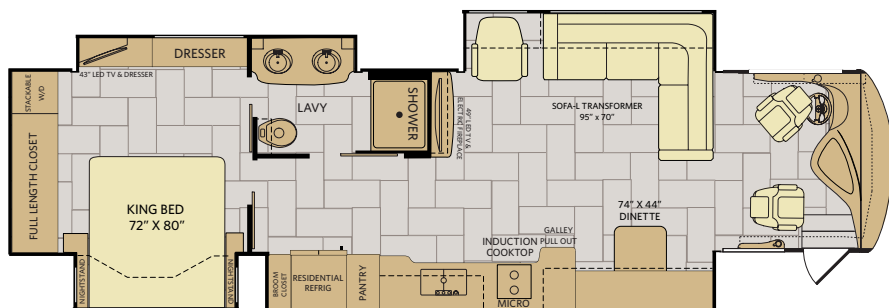

39G

Options: 087, 833

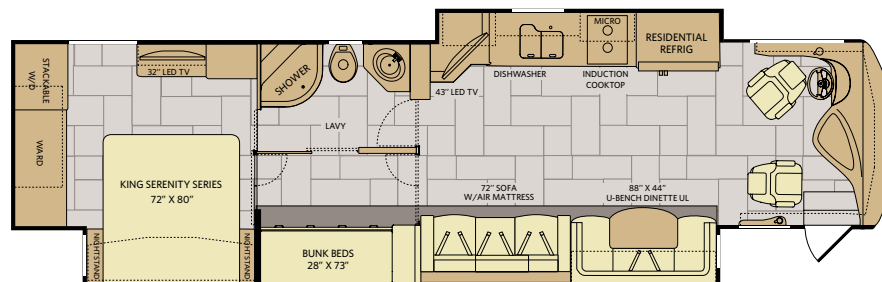

Available Options

OPT. 087
FRONT 32\"/>

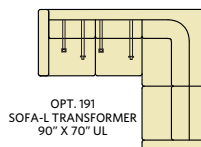

OPT. 191
SOFA-L TRANSFORMER
90\"/>



OPTION 203
95\"/>

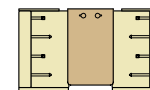

OPT. 830
FACING DINETTE

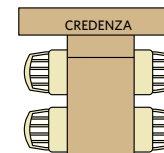

OPT. 833
FREE-STANDING DINETTE
WITH CRENZA

CRIMSON



INFINITY



SADDLE



VISION



DISCOVERY STANDARDS & OPTIONS

INTERIOR THROUGHOUT

- 20,000/25,000 BTU/ H Dual Furnaces (39G)
- 25,000/25,000 BTU/ H Dual Furnaces (37R)
- 25,000/30,000 BTU/ H Dual Furnaces (38K, 39F)
- 84' Interior Ceiling Height
- Auto Generator Start
- Central Vacuum System
- 2 Roof-Mounted, High Efficiency A/C w/Solar Panel & Bedroom Heat Pump (37R, 38K, 39F)
- 3 Roof-Mounted, High Efficiency A/C w/Solar Panel & Bedroom Heat Pump (39G)
- Fan-Tastic Power Roof Vent w/Wall Switch
- Firefly Integrations Electronic Control System
- Flat Interior Ceiling
- Tuff-Pex Plumbing System
- Demand Water Pump w/Filter
- Whole-Coach Water Filtration System
- Deluxe Roller Bearing , Full-Extension
- Drawer Guides & Transit-ship Locks
- Hardwood Cabinet Face Frames, Doors & Drawers
- Hardwood Crown Molding
- Hardwood Finish Return Air Intake for Furnace
- Manual Day/Night Double Roller Shades
- Satellite Radio (Subscription Required)
- Polished Solid Surface Countertop
- Polished Porcelain Flooring Throughout
- Passenger Console w/Integrated Magazine Rack
- Power Passenger Heated Seat w/Footrest
- Truma - Tank less Water Heater
- Quiet Cool Duct A/C
- OPTIONS**
- CSA Package (Canadian Specs)**

DRIVER CONVENIENCE

- (2) 12V Power Outlet at Dash
- 110V Power Outlet at Dash & Passenger Area
- USB Charger (Driver Side)
- Automotive Wrap-Around Dash
- Driver Left-Console w/Lower Storage Bin
- 3-Point Seatbelts at Driver & Front Passenger Seat (w/Adjustable Shoulder Straps)
- Auxiliary Start Circuit Switch
- Battery Disconnect System
- Cruise Control
- Aroura® High-Output Auto A/C Heater Combo
- Dual Dash Monitors
- Easy-Access Battery Disconnect Switch
- Front Power Roller Shades/Blinds
- Manual Driver & Passenger Roller Shade/Blinds
- Power Entry Step Cover
- Radio Switch Main/Auxiliary Power
- Remote Heated Chrome Power
- Exterior Mirrors w/Turn Signal & Side-View Cameras
- Smart Steering Wheel w/Tilt & Telescoping
- Touch Screen Radio w/Built-in GPS
- Villa Driver/Passenger Soft-touch Heated Captain's Seats w/Reclining Back & 6-Way Power Controls

SAFETY/CONVENIENCE

- 30" Wide Entry Door
- Carbon Monoxide, Propane & Smoke Detector/Alarm
- Central Electrical Panel
- Energy Management System (EMS) w/Soft Start
- Emergency E-Gress Window
- Fire Extinguisher
- Multiple Seatbelt Locations
- Neutral Loss Protection

LIVING ROOM

- 43" LED HDTV (38K, 39G)
- 49" LED HDTV (37R, 39F)
- TV Antenna w/Signal Booster
- BOSE Sound bar & Blu-Ray DVD Player
- Wall to Wall High Gloss Tile Flooring
- U-Shape Dinette (38K, 39G)
- Facing Dinette w/Credenza (37R, 39F)
- Expandable L-Sofa w/Air Mattress (39F)
- Expandable L-Sofa w/Jack-Knife (38K)
- Sofa w/Air Mattress (Queen) (37R, 39G)
- Euro Chair (37R, 39F)
- OPTIONS**
- 32" LED HDTV In Front Overhead
- Expandable L-Sofa w/Jack-Knife Footrest (37R)
- Sofa w/Air Mattress (Queen) (39F)
- Booth Facing Dinette (37R, 39F)
- Facing Dinette w/Credenza (38K, 39G)

GALLEY

- 22 cu ft. Residential Refrigerator
- Induction Cooktop
- Adjustable Cabinet Shelf (Select Cabinets)
- Dinette Base Cabinet w/Free Standing Chairs (37R, 39F)
- 2 Galley Pull-Out Extensions (39F)
- Dishwasher
- Galley Faucet w/Pullout Sprayer
- Polished Solid Surface Countertop w/Sink Covers
- Tile Backsplash
- Under-Galley Shelving & Wastebasket
- Window Over Sink (38K, 39F, 39G)

BEDROOM

- 32" LED HDTV (37R, 38K, 39G)
- 43" LED HDTV (39F)
- Bedspread w/Decorative Pillows
- King Bed (37R, 39F, 39G)
- King Exclusive Dream Easy Series w/Articulating Bed (38K)
- Rear Wardrobe w/Cedar Lining, Carpet Floor & Wire Organizer (37R, 39F, 39G)
- Dual Rear Wardrobe w/Cedar Lining, Hanging Rods (38K)
- Remote Generator Start Switch
- Slide-out Features Overhead Cabinet
- Stackable Washer & Dryer
- Wardrobe Lighting

BATHROOM

- A/C Venting
- Cabinets Toe Kicks
- Glass Shower Door
- Hardwood Bath Door/Trim
- LED Lighting Over Sink
- Molded Grani-Coat Shower Enclosure w/Skylight & Lower Threshold
- Porcelain Toilet w/Water Saver (37R, 38K, 39G)
- Porcelain Macerator Toilet (38K, 39F)
- Tile Backsplash
- Lavy Shelf in Rear Bath

EXTERIOR THROUGHOUT

- 120V/12 AC/DC Converter
- 2800-Watt Pure Sine Wave Inverter w/Remote
- 4-Point Automatic Levelers
- 50-Amp Service
- 8.0 KW Onan Quiet Diesel Generator
- Aluminum Bus-Style Side Swing Luggage Doors
- Aluminum Extruded slide Ramps
- AM/FM/DVD Sound System
- Power Awnings w/LED Light Strip & Wind Sensor React
- Clear Protective Front Mask
- Roadside DEF Tank
- Dryseal Edge Coating (Water-Wicking Wall Edge Coating)
- Exterior Entertainment Center w/32" LED HDTV and High Output, Splash proof
- Fiberglass Front/Rear Caps w/Height Mounted Taillights
- Fiberglass Wheel Well Trims
- Five-Point Built System
- Frameless Dual Pane Flush Mount Windows
- Full-Body Paint
- Manual Generator Slide
- Molded Fiberglass Roof
- Power Water Hose Reel
- Rear Ladder
- Rear Rockguard
- Remote Keyless Entry
- Seamless Beltline Trim
- Solar Electric Panel 95 Watt
- Tapered Slide-Out Box Tops & Debris Awnings
- Water Pump Switch (Multiple Locations)
- 1st Full Bay 36/90 Slide Trays (37R, 38K, 39G)
- 2nd Full Bay 36/54 Slide Trays (39F)
- OPTIONS**
- Winegard In motion Satellite Dish
- Winegard Stationary Satellite Dish
- King Dome Satellite
- Undercarriage LED Lights
- Roof Vent Rain Covers

AUTOMOTIVE

- Aluminum Wheels
- Color Rear & Side Vision Camera System
- Fog Lamps
- Large One-piece Bounded Windshield
- Mud Flaps
- Single-Motor Windshield Wipers w/Wet Arm
- Under Hood Utility Light

BODY STRUCTURE

- Basement storage
- Full Pass Through Storage w/Slide Trays
- Heated Water & Holding Tank Compartments
- Power Bridge® Chassis Construction
- Power Frames Precision Welded
- Aluminum Interlocking Frames
- Power-lock System (Interlocking Floors, Walls & Ceiling)
- Radiused & Cambered Entry Door
- Raised Space Frame Foundation
- Solid Bead-Foam Engineered Fit Insulation
- Vacu-Bond Integrated Walls
- Vacu-Bond Aluminum Framed
- Sidewalls, Roof and Floor Construction
- Full Coverage Heavy Duty Undercoating

SAFETY/CONVENIENCE

- 20' Sewer Hose
- 4-Wheel ABS Brakes
- Automatic Hydraulic Leveling Jacks
- Automotive Safety Glass
- Daytime Running Lights
- Easy Sweep Flooring at Entry Step
- Entry Door w/Screen Door & Deadbolt Lock
- Lighted Entry Assist Handle
- Power Entry Step
- Rear, Front and Side Markers Lights (Select LED)
- Solid Surface Entry-Step w/LED Accent Lights
- Toilet Tank San-T-Flush System
- Tank Sensor Monitoring System
- Utility Compartment w/Exterior Shower

STORAGE

- Continuous One-Piece Compartment Seals
- Lighted Compartments
- Pass-Through Storage

DISCOVERY LXE

Fleetwood took its most luxurious Class A and packed in even more premium features. A BOSE soundbar and Blu-Ray player, a Firefly Integrations electronic control system and tile flooring throughout take America's Favorite Motorhome to another level. The Discovery LXE offers 380-horsepower and an impressive length of over 40', providing more options on all four floorplans. Outside, a power awning with LED light strip and wind sensor react expands your family room to the Great Outdoors.

TOP FEATURES

- Power Bridge Chassis® on the Freightliner® XCM Series
- ISB 6.7L 360HP & 800 ft-lb Torque (38k & 39F)
- ISL9 8.9L 380HP & 1150 ft-lb Torque (40D, 40G, 40E, 40X)
- ISL9 450HP & 1250 ft-lb. Torque (44H)
- Firefly Integrations Electronic Control System
- High Gloss Solid Hardwood Cabinetry
- Induction Cooktop
- Polished Porcelain Tile Throughout
- Dishwasher
- Bose Soundbar w/Bluetooth Connectivity
- Residential Refrigerator
- 3RD Air Conditioner (40D, 40E, 40G, 40X, & 44H)
- Power Water Hose Reel & Power Cord Reel
- 20' Power Girard Integrated Awning w/LED Light Strip & Wind Sensor React



The Discovery LXE 40G is shown in Monarch Bronze décor and Nottingham Cherry High Gloss cabinetry.



The Discovery 39F is shown with Dark Cherry High Gloss cabinetry and features the new 2018 Galley faucet.



DISCOVERY LXE FLOORPLANS

38K Options: 087, 833

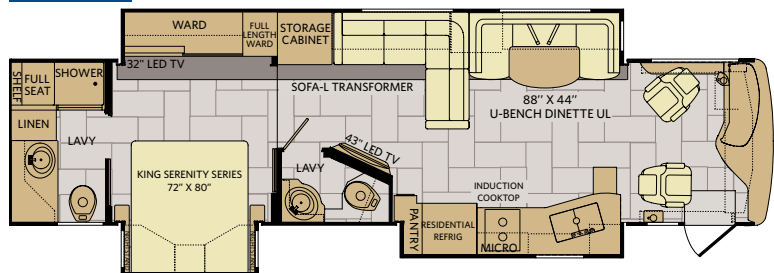

40D Options: 087, 203, 809

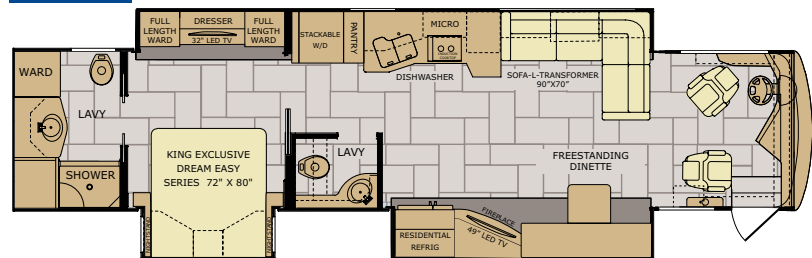

40G Options: 087, 833

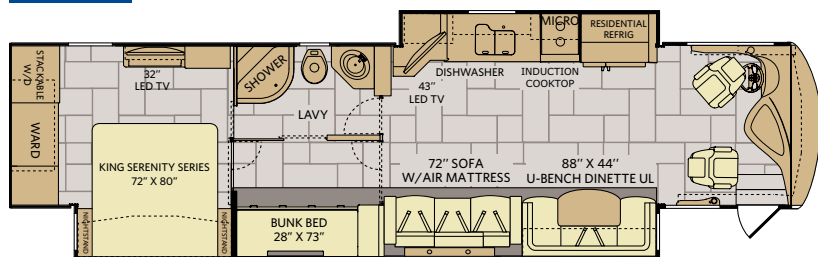

44H Options: 203, 489, 634, 830

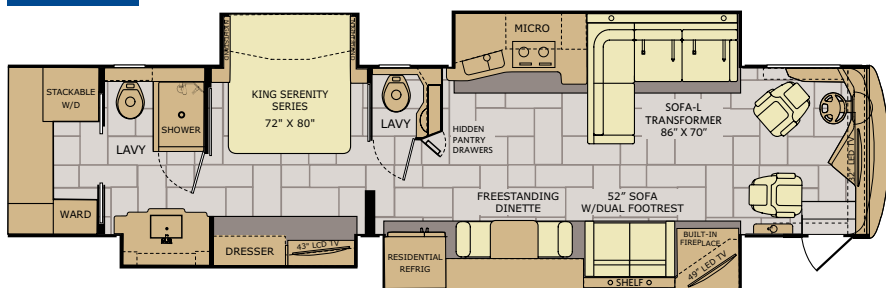

39F Options: 087, 203, 830

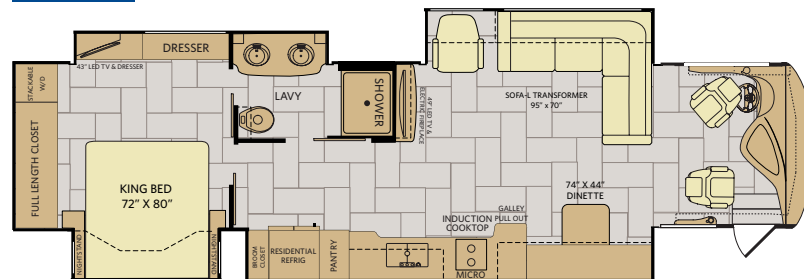

40E Options: 087

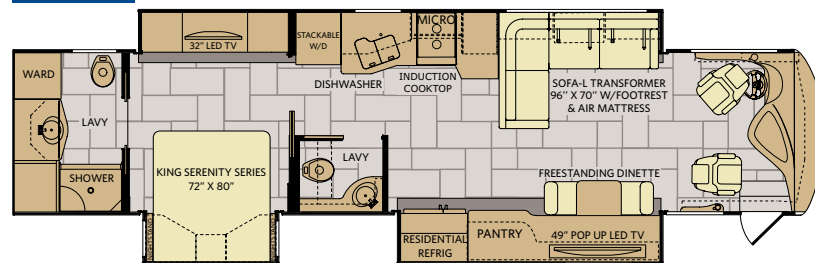

40X Options: 087, 191, 830

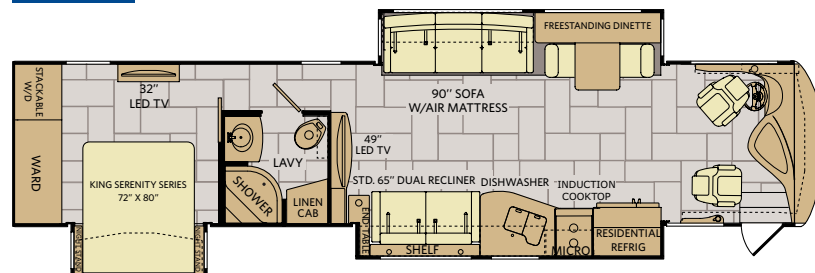

Available Options

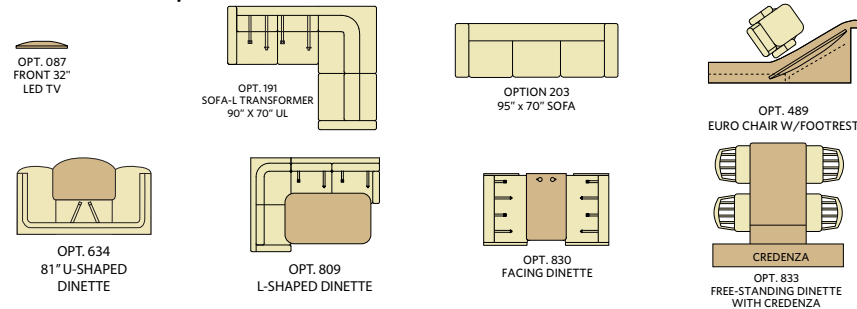

DISCOVERY LXE EXTERIORS, STANDARDS & OPTIONS

EXTERIOR OPTIONS

CHAMPAGNE



IRON

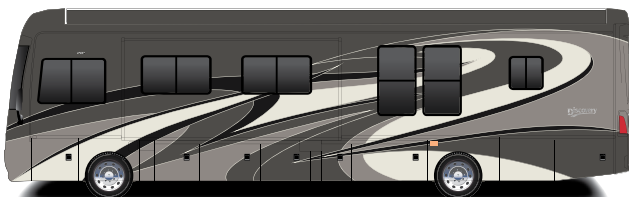

MIDNIGHT

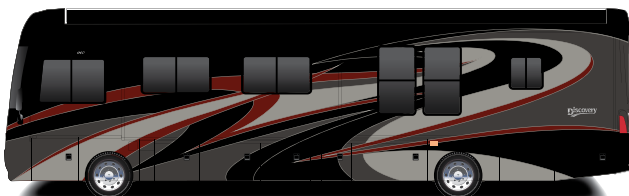

PARADISE

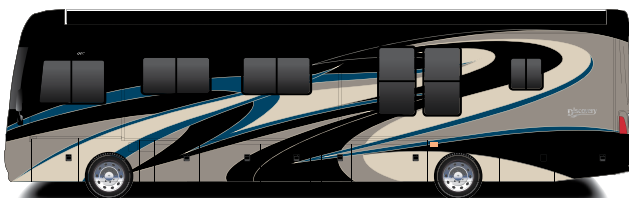

INTERIOR THROUGHOUT

- 20,000/25,000 BTU/ H Dual Furnaces (38K, 39F, 40G)
- 20,000/30,000 BTU/ H Dual Furnaces (40X)
- 25,000/30,000 BTU/ H Dual Furnaces (40E, 40D)
- Truma- Tank less Water Heater (38K, 39F, 40E, 40D, 40G, 40X)
- Aqua-Hot 400D (44H)
- 84' Interior ceiling Height
- Auto Generator Start
- Central Vacuum System
- Roof-Mounted, High Efficiency A/C w/Solar Panel & Heat Pump (2 - 38K & 39F), (3 - 40D, 40E, 40G, 40X, 44H)
- Fan-Tastic Power Roof Vent w/Wall Switch
- Firefly Integrations Electronic Control System
- Flat Interior Ceiling
- Tuff-Pex Plumbing System
- Demand Water Pump w/Filter Whole-Coach Water Filtration System
- Deluxe Roller Bearing, Full- Extension Drawer Guides & Transit-ship Locks
- High Gloss Hardwood Cabinet Face Frames, Doors & Drawers
- High Gloss Hardwood Crown Molding
- High Gloss Hardwood Finish Return Air Intake for Furnace
- Manual Day/Night Double Roller Shades
- Satellite Radio (Subscription Required)
- Polished Solid Surface Countertop
- Tile Flooring Throughout
- Passenger Console w/Integrated Magazine Rack
- Power Passenger Chair w/Footrest
- Quite Cool Duct A/C

OPTIONS

- CSA Package (Canadian Specs)**

DRIVER CONVENIENCE

- (2) 12V Power Outlet at Dash
- 110V Power Outlet at Dash & Passenger Area
- USB Charger (Driver Side)
- Automotive Wrap-Around Dash
- Driver Left-Console w/Lower Storage Bin
- 3-Point Seat Belts at Driver & Front Passenger Seat (w/Adjustable Shoulder Straps)
- Auxiliary Start Circuit Switch
- Battery Disconnect System
- Cruise Control
- Aurora® High-Output Auto A/C Heater Combo
- Dual Dash Monitors
- Easy- Access Battery Disconnect Switch
- Front Power Roller Shades/Blinds
- Manual Driver & Passenger Roller Shade/Blinds
- Power Entry Step Cover
- Radio Switch Main/ Auxiliary Power
- Remote Hatched Chrome Power Exterior Mirrors w/Turn Signal & Side-View Cameras
- Smart Steering Wheel w/Tilt & Telescoping
- Touch Screen Radio w/Built-In GPS
- Villa Driver/Passenger Soft-touch Heated Captain's Seats w/Reclining Back & 6-Way Power Controls

LIVING ROOM

- 32" Front Overhead TV(44H)
- 43" LED HDTV (38K, 40G)
- 49" LED HDTV (39F, 40D, 40X, 44H)
- 49" Pop-Up TV LIFT (40E)
- TV Antenna w/Signal Booster
- BOSE Sound bar & LG Blu-Ray/DVD Player
- Wall to Wall High Gloss Tile Flooring
- Electric Fireplace (38K, 39F, 40D, 44H)
- U-Shape Dinette (38K, 40G)
- Facing Dinette w/Credenza (39F, 40D, 40E, 40X, 44H)
- Expandable L-Sofa w/Air Mattress/ Footrest (39F, 40E)
- Expandable L-Sofa w/Jack-Knife/ Footrest (38K, 40D)
- Sofa w/Dual Footrest (40X)
- Sofa w/Air Mattress (Queen) (40G, 40X)

OPTIONS

- 32" LED HDTV In Front Overhead
- Expandable L-Sofa w/Jack-Knife (40X)
- Sofa w/Air Mattress (Queen) (40D, 44H)
- L-Shape Dinette (40D)
- Booth Facing Dinette (39F, 40X, 44H)
- Facing Dinette w/Credenza (38K, 40G)
- U-Shaped Dinette (44H)
- Euro Chair w/Footrest (44H)

GALLEY

- 22 cu ft. Residential Refrigerator & 2800 Watt Inverter
- Induction Cooktop
- Adjustable Select Cabinet Shelf
- Dishwasher
- Galley Faucet w/Pullout Sprayer
- Polished Solid Surface Countertop w/Sink Covers
- Polished Solid Surface Shelf
- Tile Backsplash
- Under-Galley Shelving & Wastebasket
- Window Over Sink (44H)

BEDROOM

- 32" LED HDTV
- 43" LED HDTV (39F, 44H)
- Bedspread w/Decorative Pillows
- King Bed (40G, 40X, 39F, 44H)
- King Exclusive Dream Easy Series w/Articulating Bed (38K, 40D, 40E)
- Rear Wardrobe w/Cedar Lining, Carpet Floor & Wire Organizer (39F, 40G, 40X)
- Dual Rear Wardrobe w/Cedar Lining, Hanging Rods (38K, 40D, 40E)
- Rear Walk-in Wardrobe w/Cedar Lining, Hanging Rods, Shoe Cabinet (44H)
- Remote Generator Start Switch
- Slide-out Features Overhead Cabinet
- Stackable Washer & Dryer
- Wardrobe Lighting

BATHROOM

- A/C Venting
- Cabinets Toe Kicks
- Emergency Egress Window
- Glass Shower Door
- Hardwood Bath Door/Trim
- LED Lighting Over Sink
- Molded Granit-Coat Shower Enclosure w/Skylight & Lower Threshold
- Porcelain Toilet w/Water Saver (38K, 40G)
- Porcelain Macerator Toilet (38K, 39F, 40D, 40E, 44H)
- Solid Surface Shelf in Rear Bath (38K, 40D, 40E, 44H)
- Tile Backsplash

SAFETY/CONVENIENCE

- 30" Wide Entry Door
- Carbon Monoxide, Propane, & Smoke Detector/Alarm
- Central Electrical Panel
- Energy Management System (EMS) w/Soft Start
- Fire Extinguisher
- Multiple Seatbelt Locations
- Neutral Loss Protection

EXTERIOR THROUGHOUT

- 120V/12 AC/DC Converter
- 2800-Watt Pure Sine Wave Inverter w/Remote
- 4-Point Automatic Levelers
- 50-Amp Service
- 8.0 KW Onan Quiet Diesel Generator
- Aluminum Bus-Style Side Swing Luggage Doors
- Aluminum Extruded slide Ramps
- AM/FM/DVD Sound System
- Power Awnings w/LED Light Strip & Wind Sensor React
- Clear Protective Front Mask
- Roadside DEF Tank
- Dryseal Edge Coating (Water-Wicking Wall Edge Coating)
- Exterior Entertainment Center w/32" LED HDTV and High Output, Splash Proof
- Fiberglass Front/Rear Caps w/High Mounted Taillights
- Fiberglass Wheel Well Trims
- Frame-less Dual Pane Flush Mount Windows
- Full-Body Paint
- Manual Generator Slide
- Molded Fiberglass Roof
- Power Water Hose Reel
- Rear Ladder
- Rear Rockguard
- Remote Keyless Entry
- Solar Electric Panel
- Tapered Slide-Out Box Tops & Debris Awnings
- Water Pump Switch (Multiple Locations)
- Undercarriage LED Lights (44H)

OPTIONS

- Exterior Entertainment Center w/48" LED HDTV and Bose Solo 5 Sound-Bar (44H)
- 1st Full Bay 36"/54" Slide Trays (40G, 40X)
- 1st Full Bay 54" Slide Trays (39F, 40D, 40E, 44H)
- 1st Full Bay 90" Slide Tray (38K, 40G, 40X, 44H)
- 2nd Full Bay 54" Slide Trays (All)
- King Dome Satellite
- Roof Vent Rain Covers
- Undercarriage LED Lights (38K, 39F, 40E, 40D, 40G, 40X)
- Window Awning Package
- Winegard In Motion Satellite Dish
- Winegard Stationary Satellite Dish

AUTOMOTIVE

- Aluminum Wheels
- Color Rear & Side Vision Camera System
- Fog Lamps
- Large One-Piece Bonded Windshield
- Mud Flaps
- Single-Motor Windshield Wipers w/Wet Arm
- Under Hood Utility Light

BODY STRUCTURE

- Basement Storage
- Full Pass Through Storage w/Slide Trays
- Heated Water & Holding Tank Compartments
- Power Bridge Chassis Construction
- Power-frames Precision Welded Aluminum Interlocking Frames
- Powerlock System (Interlocking Floors, Walls & Ceiling)
- Radiused & Cambered Entry Door
- Raised Space Frame Foundation
- Solid Bead-Foam Engineered Fit Insulation
- Vacu-Bond Integrated Walls
- Vacu-Bond Aluminum Framed Sidewalls, Roof and Floor Construction
- Full Coverage Undercoating

SAFETY/CONVENIENCE

- 20' Sewer Hose
- 4-Wheel ABS Brakes
- Automatic Hydraulic Leveling Jacks
- Automotive Safety Glass
- Daytime Running Lights
- Easy Sweep Flooring at Entry Step
- Entry Door w/Screen Door & Deadbolt Lock
- Six 6V/Deep-Cycle House Batteries
- Lighted Entry Assist Handle
- Power Entry Step
- Rear, Front and Side Marker Lights (Select LED)
- Solid-Surface Entry-Step w/LED Accent Lights
- Toilet Tank San-T-Flush™ System
- Touch Sensor Tank Monitoring System
- Utility Compartment w/Exterior Shower

STORAGE

- Continuous One-Piece Compartment Seals
- Lighted Compartments
- Pass-Through Storage

DÉCOR CHOICES

Autumn Wheat High Gloss



Nottingham Cherry High Gloss



Celestial Reflection



Monarch Bronze



Time Square



1 Sofa 2 Accent 3 Bedspread 4 Countertop 5 Flooring 6 Carpet

CHASSIS

[illegible]

Model: Freightliner® XCM Series
Engine: Cummins® ISB 6.7L
Transmission: Allison® 3000 MH 6-Speed w/Electronic Shifter
Alternator: Delco Remy 160 Amp
Torque: 800 lb.-ft. @ 1,800 RPM
Horsepower: 360 HP

DIMENSIONS & CAPACITIES

[illegible]

21 REASONS WHY FLEETWOOD IS AMERICA'S FAVORITE

Mile after mile, decade after decade, more families trust Fleetwood. The open road is our proof. With more Fleetwood motorhomes on the road today than any other manufacturer*, our brand prides itself on building dependable products that help families reconnect one journey at a time — over and over again. At Fleetwood, we constantly redefine value because understanding your every need is just the start to delivering peace-of-mind at every turn.

F-21 Advantage: Fleetwood 21st century engineering, manufacturing, and materials

Fleetwood RV offers a 21st century, industry-leading advantage—a quality construction approach to motorhome engineering, manufacturing and materials. The “F” stands for Fleetwood RV. The “21” stands for 21st century materials and construction techniques. F-21 is demonstrated by 21 key proof points that deliver unique advantages to Fleetwood owners and illustrate the quality for which Fleetwood RV is known industry-wide.

*Based on IHS Automotive, Polk Recreational Vehicles in Operation (RVIO) as of 7/1/13.



REV GROUP

LAMESA RV

EXPERIENCE LIFE

www.lamesarv.com
800-496-8778



Fleetwood RV is part of REV Recreation Group, a division of REV Group, Inc., a family of 26 industry-leading motor vehicle brands. At REV Group, we innovate, design and build products that connect and protect thousands of people every day—our trusted vehicles are engineered with the utmost rigor and precision to deliver the highest levels of performance, reliability, durability and safety.

DISCLAIMERS

1. GVWR (Gross Vehicle Weight Rating) is the maximum permissible weight of this fully loaded motor home. The GVWR is equal to or greater than the sum of the (UVW) unloaded vehicle weight plus the (OCCC) occupant cargo-carrying capacity.
 2. GAWR (Gross Axle Weight Rating) is the maximum permissible loaded weight a specific axle is designed to carry.
 3. GCWR (Gross Combined Weight Rating) is the value specified by the motor home manufacturer as the maximum allowable loaded weight of this motor home with its towed vehicle. Towing and braking capacities may be different. Refer to Fleetwood and chassis manufacturer's manuals for complete information.
 4. Length measured from front bumper to rear bumper (excludes accessories).
 5. Excludes safety equipment and awnings.
 6. Motor homes feature a body width over 96" which will restrict your access to certain roads. Before purchasing, you should research any state and/or province road laws which may affect your usage.
 7. Tank manufacturer's listed water capacity (WC). Actual propane capacity is 80% of water listing as required by the safety code.
- † The chassis manufacturer recommends the installation of a supplemental brake control system to activate the brakes on the vehicle or trailer you are towing. Hitch receiver ratings expressed are maximum for the hitch receiver installed and may require the purchase of additional equipment that is dependent on the weight of the towed load. Consult with hitch receiver manufacturer for further information.
- * UVW and OCCC are found on the label containing the federal certification tag in each RV.
- ** Seatbelts and locations are shown in the brochure for display purposes only. Actual numbers and locations will vary by model.
- *** All 2018 REV Recreation Group motorhomes include a limited one year/15,000-mile coach warranty and three-year/45,000-mile structural warranty, whichever occurs first, and is fully transferable for the first 12 months.

FLEETWOOD MOTORHOME ASSOCIATION

As a Fleetwood RV owner, you're invited to become a member of the Fleetwood Motorhome Association (FMA). Becoming a member is the perfect way to meet other Fleetwood owners who love to travel across America and share in the RV lifestyle. Visit the FMA website at www.fma4fun.org to learn more and join the fun.

CONTACT US

To locate a dealer near you, visit our website at www.fleetwoodrv.com or call 1-800-322-8216. We can also be contacted at Fleetwood RV Customer Relations, P.O. Box 1007, Decatur, IN 46733.

IMPORTANT—PLEASE READ: Product information, photography and illustrations included in this publication were as accurate as possible at the time of printing. For further product information and changes, please visit our website at www.fleetwoodrv.com or contact your local Fleetwood RV dealer. Prices, materials, design and specifications are subject to change without notice. All weights, fuel, liquid capacities and dimensions are approximate. Fleetwood RV has designed its recreational vehicles to provide a variety of uses for its customers. Each vehicle features optimal seating, sleeping, storage and fluid capacities. The user is responsible for selecting the proper combination of loads (i.e., occupants, equipment, fluids, cargo, etc.) to ensure that the vehicle's capacities are not exceeded.

www.fleetwoodrv.com

©2017 REV Group, Inc. Printed in the USA. Inventory Control Number DISDISLXE18B1, 06/17. Model Year 2018, First Edition.